

ASCENT X¹ QUICKSTART GUIDE

START HERE

1 Carefully remove all items from box

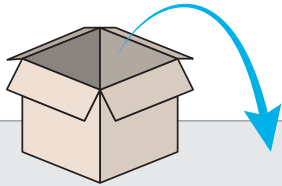

2 Open front cover of Ascent X1 for access to internal components

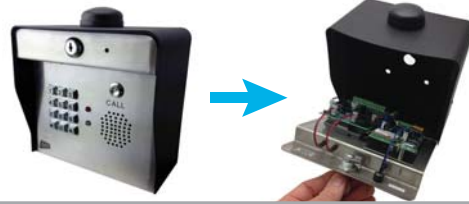

3 Feed wiring harness through pedestal body



4 Feed wiring harness through back of Ascent X1 and bolt to pedestal

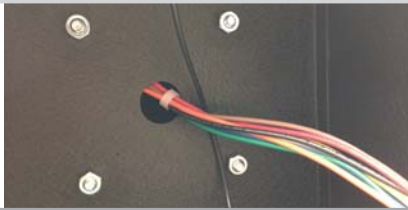

5 Twist ground wires (green) together clockwise and fasten with wire nut

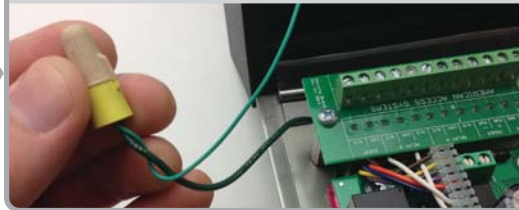

6 Attach power wires (red & black) to Ascent X1 terminal block



7 Attach power wires (red & black) to supplied 12 VDC transformer



⚠ CAUTION!

If you will not be using the supplied 12 VDC transformer, please go to **page 3** and follow the procedure to connect a third-party power source.

Failure to choose a compatible power source can damage Ascent!

8 Attach relay wires (orange & brown) to Ascent X1 terminal block



9 Attach relay wires (orange & brown) wires to gate operator

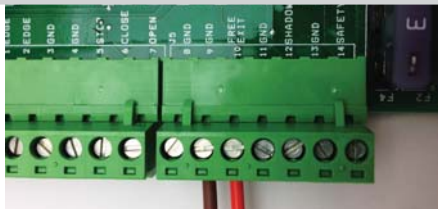

10 If free exit used, attach COM & N/O wires to Ascent X1 terminal block



11 If status used, attach N/O & GND wires from Ascent X1 to Close Limit



ASCENT X¹ QUICKSTART GUIDE

Installing Custom SIM Card (Optional)



- 1** Locate supplied SIM card and slide card holder cover to "OPEN"

- 2** Lift up on card holder cover and remove SIM card

- 3** Repeat steps in reverse to install new SIM card and lock it in place

PROGRAMMING

Adding Codes

- 1** Enter master code (default 1251) and listen for confirm tone

- 2** Press 1 and listen for confirm tone

- 3** Enter all codes to be added; listen for confirm tone. Press # to save and exit.

Deleting Codes

- 1** Enter master code (default 1251) and listen for confirm tone

- 2** Press 2 and listen for confirm tone

- 3** Enter all codes to be deleted; listen for confirm tone. Press # to save and exit.

! IMPORTANT!

Please test Ascent and make sure it operates properly before continuing. If it does not operate properly, please contact us at summitcontrol.com/contact

Now follow the **ACTIVATION GUIDE** to create an account and begin using Ascent.



ASCENT X¹ QUICKSTART GUIDE

Using a Third-Party Power Source (Optional)

! IMPORTANT!

If you would like to use a third-party power source, such as solar, verify that it conforms to the following specs.

Input 12-24 VAC / VDC
must be within ±10%

Current Draw less than 100 mA @ 12 VDC
less than 75 mA @ 24 VDC
standby with nightlight

less than 150 mA @ 12 VDC
less than 125 mA @ 24 VDC
with relay latched

! CAUTION!

Ensure red wires are connected to positive (+) terminals and black wires are connected to negative (-) terminals, as shown in the following steps.

Reverse polarity can damage Ascent.

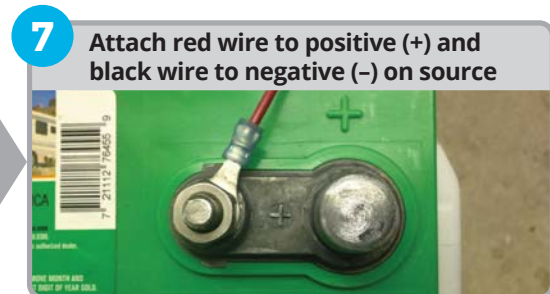
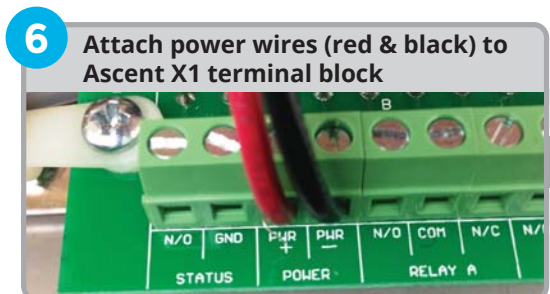

Continue at Step 8!